



YubiOn

WindowsLogon Standalone

User's Manual

- ATKey Version

Created on 07/30/2024.

SoftGiken Co., Ltd.

Before logging on to Windows using ATKey

Before using this application, users must set up ATKey themselves.

Follow the steps below to register your fingerprint and PIN.

Do not reset the security key when setting up ATKey.

Settings for using this application will be lost.

1. Start "Windows Hello setup".

Right-click on the Start menu and open "Settings".

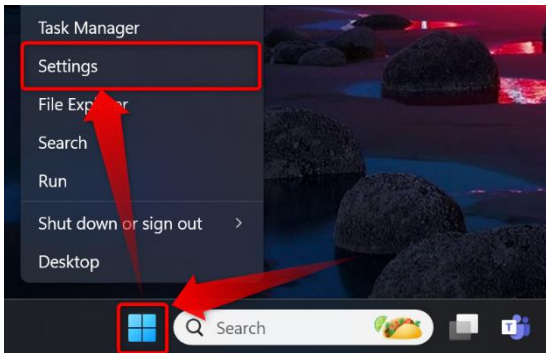

Click on "Sign-in options" under "Accounts."

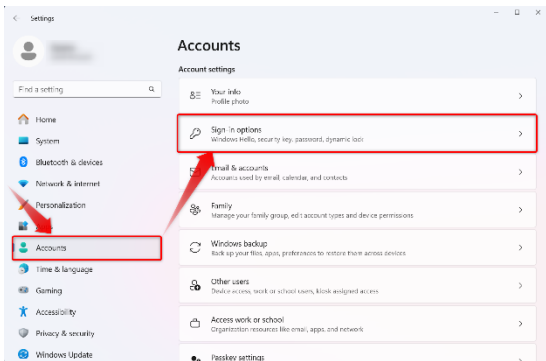

Click the "Manage" button under "Security key."

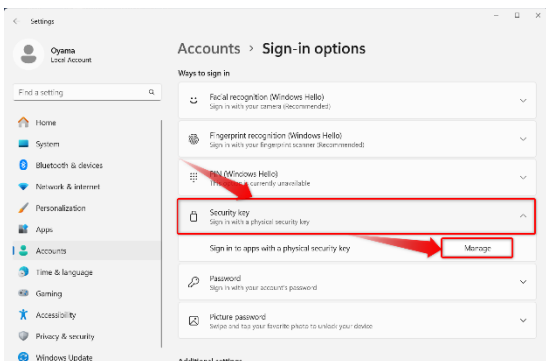

"Windows Hello setup" will open.

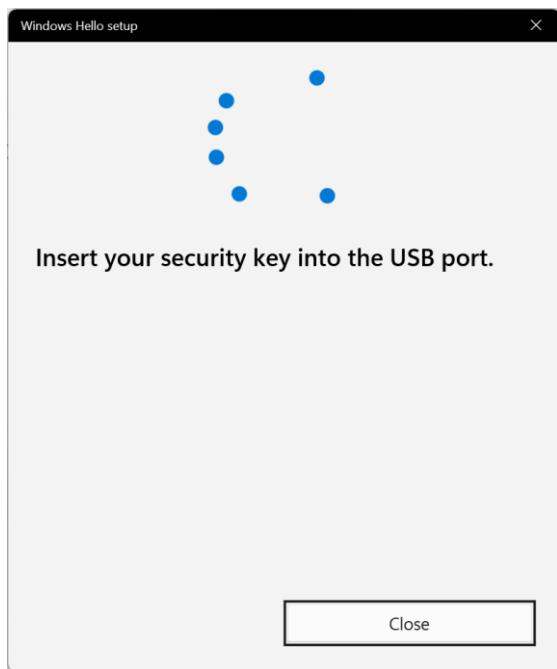

2. Insert ATKey into the USB port and touch the sensor part.

When you insert the ATKey into the USB port, you will be prompted to touch the security key.

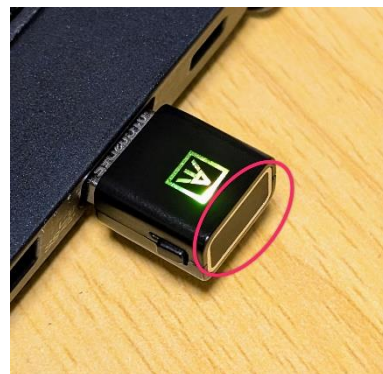
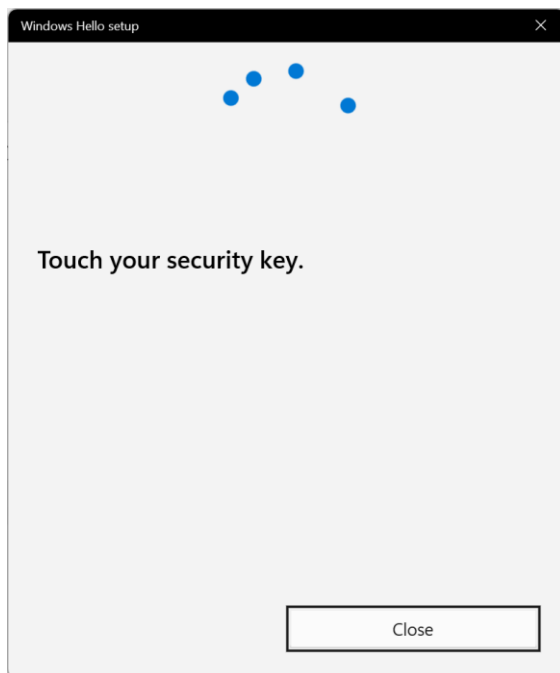

3. Register your PIN.

Please be sure to register your PIN. If the PIN is not registered, additional fingerprint information cannot be registered or deleted.

Click the "Add" button for the Security Key PIN.

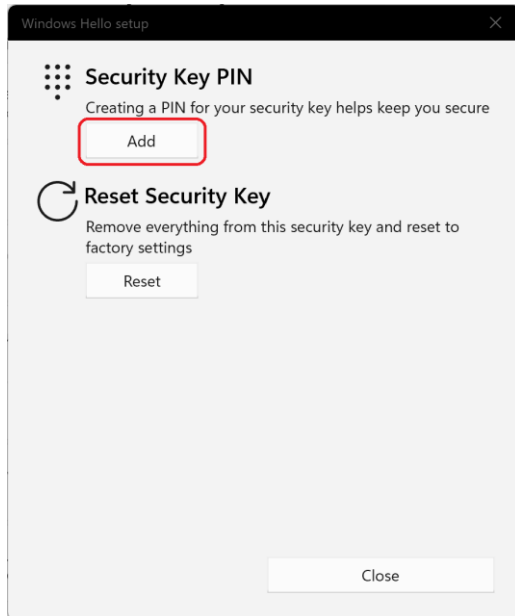

Enter a new PIN and a confirmation PIN, then click the "OK" button.

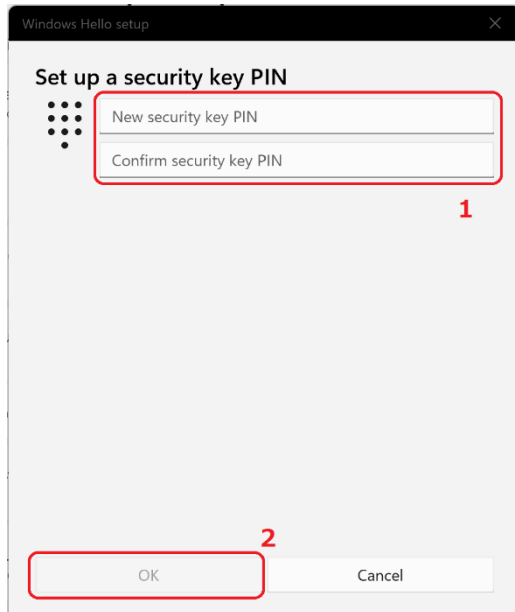

When the PIN registration is completed, the "Add" button for the Security Key PIN will change to the "Change" button.

4. Continue to register your fingerprints.

Before fingerprint enrollment, PIN enrollment is required.

Click the "Setup" button on the Security Key Fingerprint.

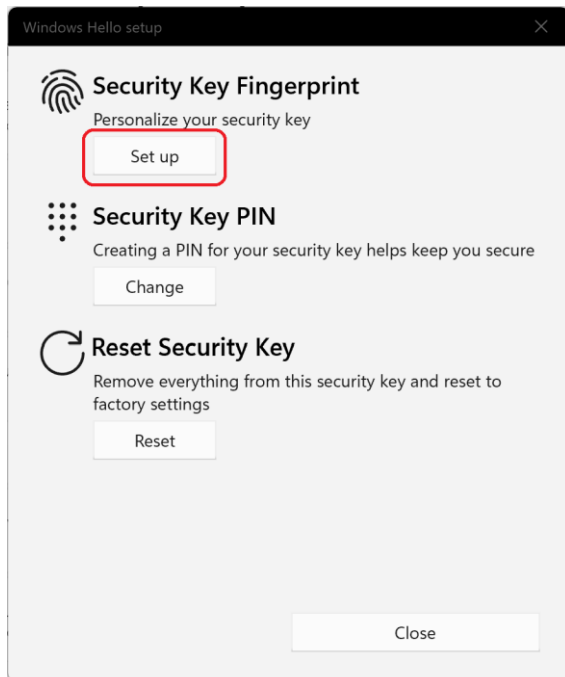

To confirm your identity, enter the PIN you have just registered.

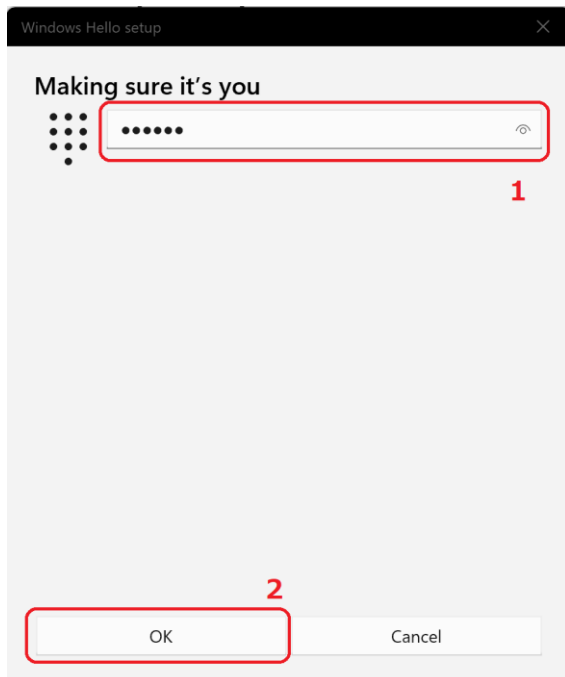

You will be prompted to touch the fingerprint sensor. Follow the on-screen instructions and repeat the action of lifting and resting your finger on the ATKey's sensor.

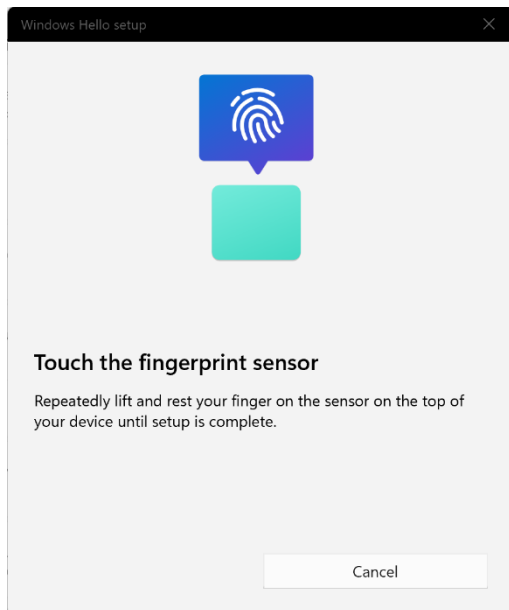

After completing the fingerprint enrollment, click the "Done" button.

If you want to register another fingerprint

The maximum number of fingerprints that can be registered with ATKey.Pro is 10.

Start "Windows Hello Setup" in the same way as when enrolling a PIN/fingerprint. Click the "Add another" button for the Security Key Fingerprint.

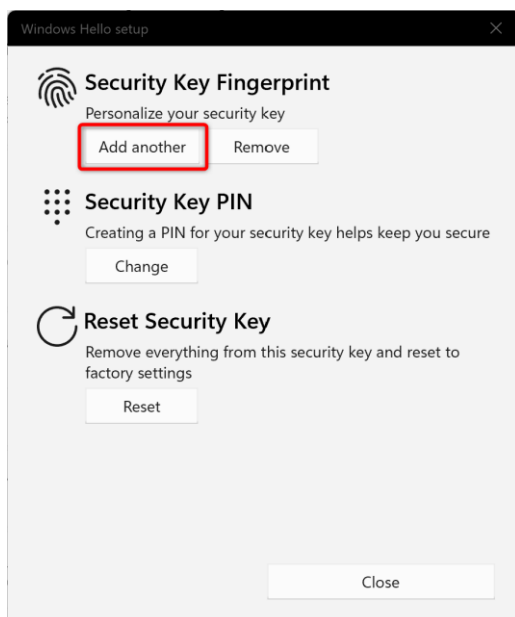

Thereafter, follow the same procedure as for fingerprint enrollment.

If you want to delete fingerprint information

- Do not reset the security key. The settings for using this application will be lost.
- Deleting fingerprint information will delete all fingerprint information registered in ATKey.

Start "Windows Hello setup" in the same way as for PIN/fingerprint registration.

Click the "Remove" button on the Security Key Fingerprint.

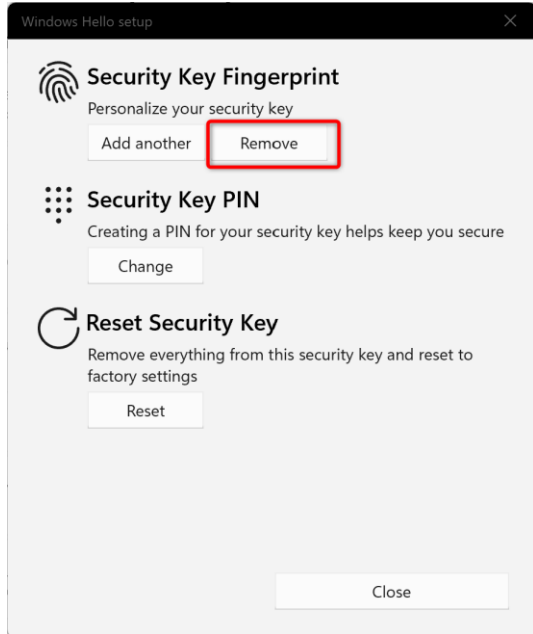

Enter your registered PIN to confirm your identity.

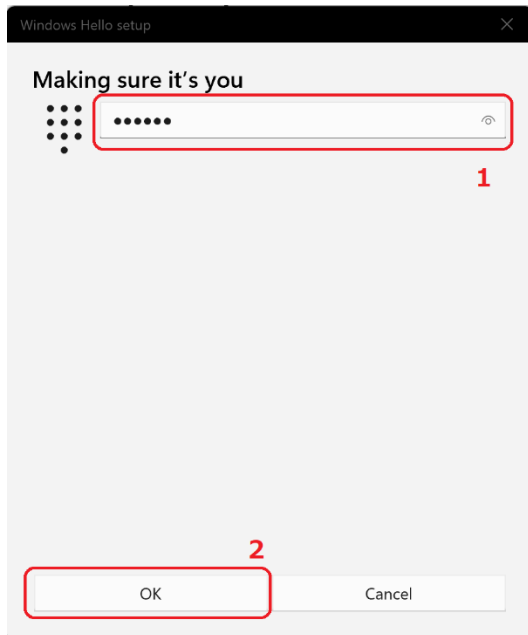

Entering the correct PIN will delete all registered fingerprint information.

How the user logs on

Devices that apply two-factor authentication settings with this application must log on by entering a one-time password (OTP) by ATKey following the Windows passwords.



Hereafter, we will explain how to log on with two-factor authentication using ATKey.

1. Start the device and select or enter a user to log on.

Confirm that "YubiOn® WindowsLogon Standalone" is displayed below the logon user name.

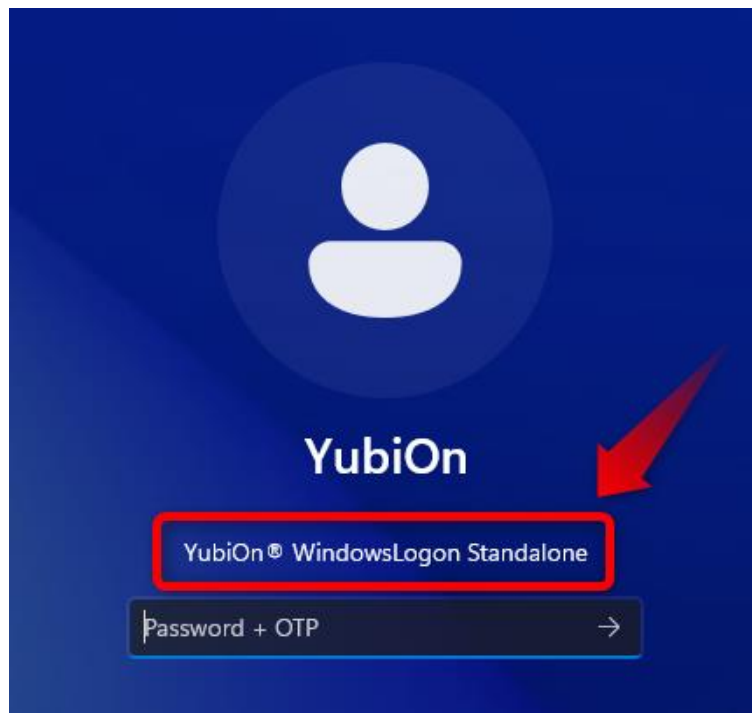

[Information] If YubiOn is not displayed on the logon screen

If you do not see the above, click on "Sign-in options" and then on "YubiOn® WindowsLogon Standalone (authenticator icon)".



***If the user of this application is forced (in Secure mode), "Sign-in options" will not be displayed.**

[Information] If YubiOn is not displayed in the sign-in options

If the "YubiOn® WindowsLogon Standalone" icon is not displayed even after opening "Sign-in options", YubiOn settings are required, so please contact the person in charge of settings.

2. Enter your Windows password in the password entry field.

Do not press Enter at this stage.



3. Insert your ATKey into the USB port.

Make sure that the OTP mode (lit yellow) is selected.



[Information] If you are not in OTP mode

If the device is in FIDO2 mode (lit blue) after insertion, press the switch on the side of the device to switch to OTP mode (lit yellow).

*FIDO2 mode is not used in this application.



4. With the password entered, tap the sensor portion of the ATKey.

Tapping ATKey will automatically enter the Enter key after the OTP output.

Taps to ATKey must be made with a finger that is registered with the fingerprint

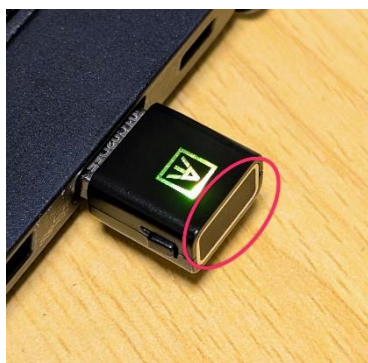

After entering the ATKey, if the "Windows password" and "ATKey one-time password" are correct, the logon will be successful.

[Information] When logon fails

If two-factor authentication using ATKey fails, the following are possible reasons.

- Input was made with Caps lock enabled.
Disable Caps lock and tap ATKey.
- OTP is not output correctly due to poor contact of the device's USB port or USB hub.
Please check the connection of ATKey and make sure that the one-time password is output normally.
- The entered Windows password is incorrect.
Make sure you are entering the correct Windows password.
- An ATKey that has not been assigned to a logon user was used.
In this case, please contact the person in charge of setting this application.

How to check the one-time password output (For ATKey)

1. Insert the ATKey into the USB port.
2. Verify that the OTP mode (lit yellow) is selected.
3. Open a text editor.
4. Touch the metal part of the ATKey.
5. It is normal if a string of 44 characters is printed. (half-width input)

[Caution] If fingerprint authentication fails consecutively

If the fingerprint authentication fails three times in a row, the key turns red and cannot be authenticated. In this case, remove the device from the USB port and reinsert it before authentication.

Please note that if you make this "3 consecutive failures" 5 times in a row (15 times in total), the key will no longer be available.